

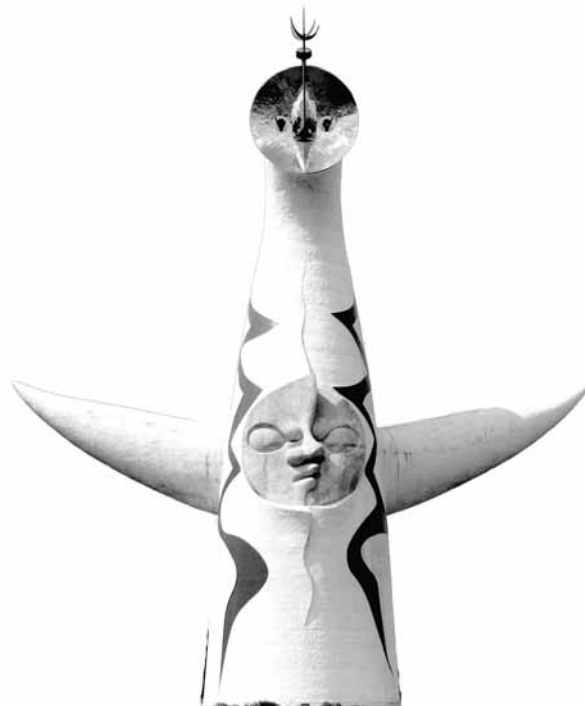

**Program of the
International Conference on Ecological Restoration
in East Asia 2006, OSAKA**

16 (Fri) – 18 (Sun) June 2006, Osaka, Japan



Venue

Hotel Hankyu Expo Park
<http://www.htl-expopark.jp/en/index.html>



Organized by

International Consortium of Landscape and Ecological Engineering (ICLEE*)

&

International Association for Landscape Ecology Asia-Pacific Region

(IALE Asia-Pacific Region)

* ICLEE: Japanese Society of Revegetation Technology (JSRT), Ecology and Civil Engineering Society (ECES), Japan Association for Landscape Ecology (JALE), Korea Society for Environmental Restoration and Revegetation Technology, Korean Institute of Landscape Architecture, Korean Society of Environmental Ecology, Chinese Landscape Architects Society in Taiwan

Cosponsored by

Commemorative Organization for the Japan World Exposition '70

Supported by

Ministry of Environment Japan, Ministry of Land, Infrastructure and Transport Japan, Ministry of Agriculture, Forestry and Fisheries Japan, Osaka Prefectural Government, Suita City Government, National Park Association of Japan, Organization for Landscape and Urban Green Technology Development, Foundation for Riverfront Improvement and Restoration, Natural Environment Coexistence Technology Association, Japan Greenery Research and Development Center

Executive committee

Chair:	Yukihiro MORIMOTO (JSRT / Kyoto Univ., Japan)
Vice-chair:	Nobukazu NAKAGOSHI (JALE / Hiroshima Univ., Japan)
	Yasuro KADONO (ECES / Kobe Univ., Japan)
	Kwi-gon KIM (ICLEE / Seoul National Univ., Korea)
Secretary General:	Shozo SHIBATA (JSRT / Kyoto Univ., Japan)
Program:	Mahito KAMADA (JALE / Tokushima Univ., Japan)
	Michiro FUJIHARA (JALE / Awaji Landscape and Horticulture Academy, Japan)
	Atsuo MORIMURA (JSRT / Univ. of Human Environment, Japan)
	Yoshihiro NATUHARA (JALE / Osaka Pref. Univ., Japan)
	Akihiro NAKAMURA (JERT / Osaka Pref. Univ., Japan)
	Kazumi TANIDA (ECES / Osaka Pref. Univ., Japan)
	Futoshi NAKAMURA (ECES / Hokkaido Univ., Japan)
General Affairs:	Yoshiyuki HIOKI (JSRT / Tottori Univ., Japan)
	Hideyuki NIWA (JALE / Macrovision Urban Planning & Architecture, Japan)
	Seiji FURUKAWA (ECES / Hydraulic Planning Institute, Japan)
	Yukiko ONO (General Environmental Tenhno Co., Ltd., Japan)
	Yutaka IWASAKI (JSRT / Chiba Univ., Japan)
Treasury:	Yumi SHIMAZAKI (ECES, Japan)
	Tatsuaki KOBAYASHI (JSRT / Chiba Univ., Japan)
Auditor:	Keiji SAKAMOTO (JSRT / Okayama Univ., Japan)
	Mamoru YAMADA (JSRT / Hiroshima Univ., Japan)
Secretariat:	Junichi IMANISHI (JSRT / Kyoto Univ., Japan)
	Takashi OYABU (JSRT / Awaji Landscape and Horticulture Academy, Japan)
	Jeung-Hyun KOH (JSRT / Kyoto Univ., Japan)

Schedule, Rooms and Time tables of the Parallel Symposium

16 (Fri)	8:00-9:20	9:20 - 9:30	09:30 - 10:10	10:15 - 12:45	12:45 - 13:30	13:30 - 17:00
	Reception	[Room Sei-un] Opening Statement	Plenary talk	Parallel symposium	Lunch	Poster session
			[Room Sei-un] Conservation of plant diversity in Korea [Kim Yong-sik, Korea]	[Room Sei-un] 1. Landscape ecological concept in ecological restoration planning [Chaired by Hong S.K., Fujihara M. & Bogaert J.]		
			[Room Sei-un] Human Intervened Post-fire Forest Restoration in the Northern Great Hing'an Mountains: A Review [Li Xiuzhen, China]	[Room Gekko-1] 2. Management of rural ecosystems and biodiversity 1 [Chaired by Nakamura K., Storozhenko S.Y. Shibata S. & Sakamoto K.]		
			[Room Gekko-2] 3. Management and restoration of river and floodplain [Chaired by Asaeda T. & Kamada M.]			
				[Room Mizudori] 4. Technology for ecological restration [Chaired by Kim N.C. & Imanishi J.]		

17 (Sat)	9:00 - 9:40	9:45 - 12:30	12:30 - 13:30	13:30 - 17:00	18:00 -	
	[Room Sei-un] Establishment of type classification for national wetland, Republic of Korea [Kim Kwi-gon, Korea]	Plenary talk	Parallel symposium	Lunch	Open Symposium	
		[Room Sei-un] Ecological restoration and collaborative management of lakeshore vegetation in Lake Kasumigaura [Nishihiro Jun, Japan]	[Room Sei-un] 5. Monitoring and evaluation of habitats. [Chaired by Natuhara Y., Peng S. & Morimoto J.]		[Room Gekko-1] 6. Management of rural ecosystems and biodiversity 2 [Chaired by Nakamura K., Storozhenko S.Y. Shibata S. & Sakamoto K.]	[Room Gekko] Nobukazu Nakagoshi, Giovanni Sanesi, Alice Sharp, Hou-Nan Tsai, Bo-chul Whang, Yukihiro Morimoto
			[Room Gekko-2] 7. Management of watershed and wetland. [Chaired by Kim K.G., Nakamura F. & Kadono Y.]		[Room Mizudori] 8. Policy and public involvement [Chaired by Nishihiro J. & Kobayashi T.]	
			Banquet			

18 (Sun)	Excursion
----------	-----------

16 (Friday)			
	9:20 - 10:10	10:15 - 12:45	13:30 - 17:00
Sei-un	Opening statement Plenary talk	Parallel symposium 1	Poster session
Gekko-1		Parallel symposium 2	
Gekko-2		Parallel symposium 3	
Mizudori		Parallel symposium 4	

Time table of parallel symposium		
10:15	10:30	1
10:30	10:45	2
10:45	11:00	3
11:00	11:15	4
11:15	11:30	Break
11:30	11:45	5
11:45	12:00	6
12:00	12:15	7
12:15	12:30	8
12:30	12:45	9

17 (Saturday)			
	9:00 - 9:40	9:45 - 12:30	13:30 - 17:00
Sei-un	Plenary talk	Parallel symposium 5	Open symposium
Gekko-1		Parallel symposium 6	
Gekko-2		Parallel symposium 7	
Mizudori		Parallel symposium 8	

Time table of parallel symposium		
9:45	10:00	1
10:00	10:15	2
10:15	10:30	3
10:30	10:45	4
10:45	11:00	5
11:00	11:15	Break
11:15	11:30	6
11:30	11:45	7
11:45	12:00	8
12:00	12:15	9
12:15	12:30	10

Floor Map - Hotel Hankyu Expo Park

Reception	Lobby(2F)
Plenary Talk	Seiun 2(2F)
Parallel Symposium	Seiun 2(2F), Gekko 1-2(2F), Mizudori(3F)
Poster Session	Gekko 1-2(2F), Lobby(2F)
Open Symposium	Gekko 1-2(2F)
Banquet	Izumi(East Building, 1F)

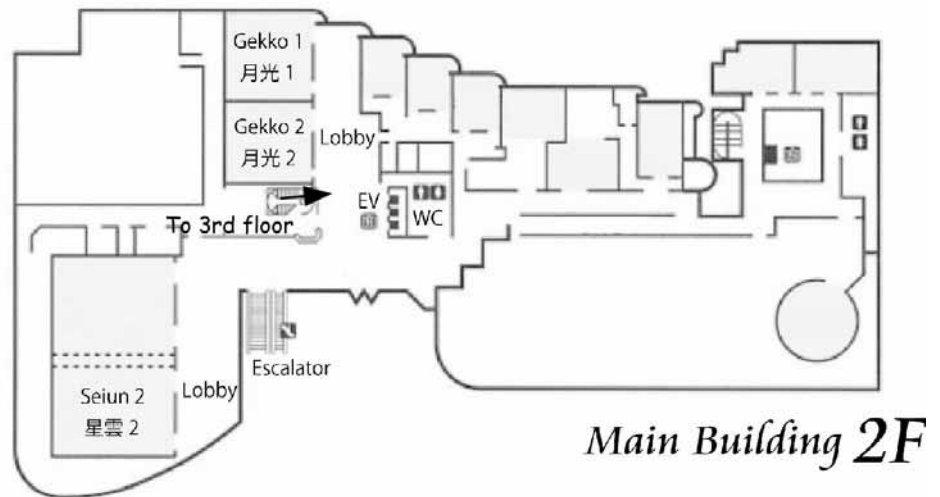
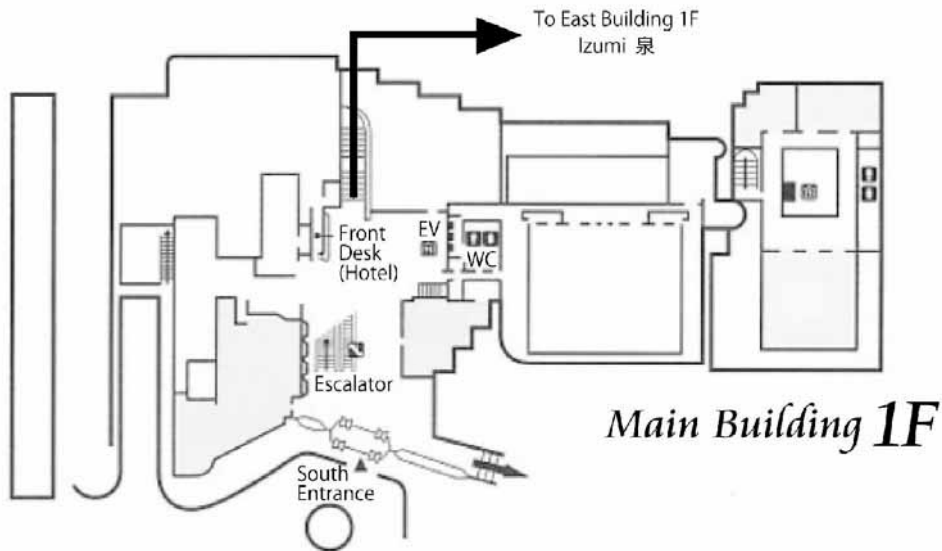

Poster Session

Jun 16 13:30-17:00

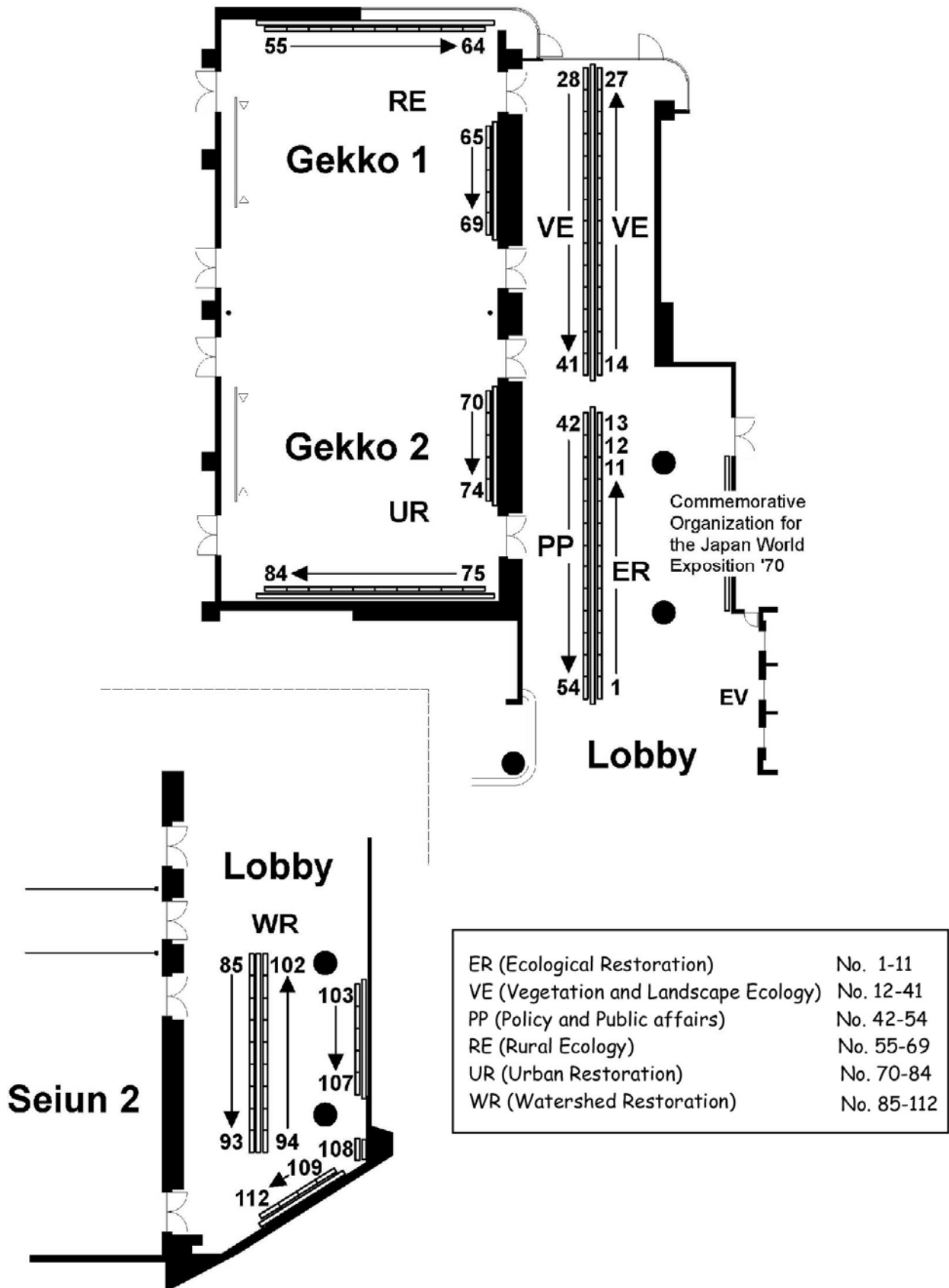

ER (Ecological Restoration)	No. 1-11
VE (Vegetation and Landscape Ecology)	No. 12-41
PP (Policy and Public affairs)	No. 42-54
RE (Rural Ecology)	No. 55-69
UR (Urban Restoration)	No. 70-84
WR (Watershed Restoration)	No. 85-112

Notice to Speakers

Oral presentations:

Check of slides: Speakers must gather at the room at least 20 minutes before starting the session, and check your slides. We strongly recommend you to put your presentation file into the computer that is set at the room, in order to save your presentation time.

Staffs will help your setting.

Slide operation: Operate the computer by yourself.

Time of presentation: Each oral presentation is restricted to a total of 15 minutes, including a 12-minute presentation and a 3-minute discussion. Please keep your time.

Poster presentations:

Poster size: The size of poster must be within 0.9 m (width) x 1.8 m (height).

Setting and removal: You can attach poster(s) before starting opening statement and plenary talk (till 9:20) and during lunch time (12:45 - 13:30).

Poster setting during the time of parallel symposium is strictly inhibited, particularly in the Room Gekko-1 and 2 (Poster No. 55-84). We are sorry for your inconvenience.

Please remove your poster(s) by yourself after the poster session.

Core time for presentation: Speakers in the poster session are divided into three groups for presentation. Speakers belonging to Group I should stand next to your poster and explain from 13:40 to 14:30, Group II from 14:40 to 15:30 and Group III from 15:40 to 16:30. See the program to confirm the group that you belong to.

Poster prize: Poster prize is provided. The winners will be announced just after the closing time of the poster session. The winning poster will be exhibited during 17th and the winners will be introduced during the banquet.

Program

Plenary Talk / Room Sei-un

16 (Friday) 9:30 – 10:10

Yong-sik KIM	Conservation of plant diversity in Korea
Xiuzhen LI, Fujun XIE, Xugao WANG, Fanhua KONG	Human intervened post-fire forest restoration in the Northern Great Hing'an Mountains: A review

17 (Saturday) 9:00 – 9:40

Kwi-gon KIM	Establishment of type classification for national wetland, Republic of Korea
Jun NISHIHIRO	Ecological restoration and collaborative management of lakeshore vegetation in Lake Kasumigaura

Parallel Symposium

16 (Friday) 10:15 – 12:45

1. Landscape ecological concept in ecological restoration planning [Chaired by Hong S.K., Fujihara M. & Bogaert J.] / Room Sei-un
--

O-1	Jan BOGAERT	The use of spatial pattern analysis to support landscape planning and biological conservation
O-2	Liangjun DA, Nana LIU, Yuan PENG	The theory and practices of approx-natural eco-restoration in urban area of Shanghai, China
O-3	Sampei YAMASHITA, Naofumi NAKAMURA	Visual aesthetic quality of the middle landscape in a catchment basin
O-4	Michiro FUJIHARA, Masaharu KISHITANI	A conservation target based on the historical landscape analysis in a rural area
O-5	Jae-Eun KIM, Sun-Kee HONG, Nobukazu NAKAGOSHI	Suitable management areas for rural landscape planning using AHP (Analytic Hierarchy Process)
O-6	Byungseol BYUN, Sun-Kee HONG	Sustainable development and ecological preservation at island area in Korea
O-7	Norio TANAKA, Yasushi SASAKI, M.I.M. MOWJOOD, K.B.S.N. JINADASA, Junji YAGISAWA	Effects and limitation of coastal vegetation on and behind the sand dune at the Indian Ocean tsunami and important points for future restoration
O-8	Li-Ding CHEN, Bo-Jie FU, Hui-Ying TIAN	How to integrate the landscape pattern analysis and ecological processes? - A conceptual model

2. Management of rural ecosystems and biodiversity 1 [Chaired by Nakamura K., Storozhenko S.Y., Shibata S. & Sakamoto K.] / Room Gekko-1

- | | | |
|------|---|---|
| O-9 | Koji NAKAMURA | Long-term monitoring and restration of biodiversity in Satoyama |
| O-10 | Sergey Yu. STOROZHENKO, Sergey K. KHOLIN | The ground beetles (Coleoptera: Carabidae) assemblages in natural and anthropogenic ecosystems of Sikhote-Alin Mts, Russian Far East |
| O-11 | LINAWATI, Koji NAKAMURA | Changes in diversity and structure of ground beetles (Coleoptera : Carabidae) during the restoration of Satoyama in Kanazawa, Japan |
| O-12 | Daisuke AKAISHI, Koji NAKAMURA | Comparative study of macrofungal flora between two different satoyama forests |
| O-13 | Kazuya KIMURA, Shin-ichi TANABE, Koji NAKAMURA | Occurrence of fall-winter frugivorous birds in secondary forests established in rural and urban areas of Hokuriku district, central Japan |
| O-14 | Tetsuya KASAGI | Changes in plant species diversity after management in Satoyama. |
| O-15 | Ikuyo SAEKI | Effects of tree cutting and mowing on plant species composition and diversity of the rare maple-dominated wetlands |
| O-16 | Koji IWASE, Takamichi ORIHARA, Takashi OYABU, Yuriko IKEDA, Masahide YAMATO, Toshihiro KURUSU, Yukiko ONO | Adaptation of introduced exotic tree, <i>Eucalyptus</i> , to Japanese environment |
| O-17 | Daisuke UTSUNOMIYA, Koji NAKAMURA | Pollination system in Satoyama forest |

3. Management and restoration of river and floodplain [Chaired by Asaeda T. & Kamada M.] / Room Gekko-2

- | | | |
|------|---|--|
| O-18 | Takashi ASAEDA, Takeshi FUJINO, Lalith RAJAPAKSE | Effects of flood patterns on the growth of <i>Phragmites japonica</i> - application for the flood plain management- |
| O-19 | Daisuke NAKANO, Futoshi NAKAMURA | Longitudinal chages in predominant factors structuring benthic invertebrate communities in a river of Northern Japn |
| O-20 | Rui SATO, Yasunori KOZUKI, Minoru SHIRATORI, Yoshikazu SHIMADA, Ryuichi KITTA, Hitoshi MURAKAMI | Effects of the water discharge on periphyton downstream of the dam |
| O-21 | Takeyoshi CHIBANA | Flow characteristics of pools formed in the middle reach of rivers |
| O-22 | Jin Hong KIM, Jeon young YANG | Hydraulic Effect on Vegetation Behavior in a Sand Bar |
| O-23 | Shamal Chandra DAS, Norio TANAKA | The effect of stem breaking/bending of two rhizomatous plants, <i>Phragmites australis</i> and <i>Miscanthus sacchariflorus</i> on the floodplain vegetation |
| O-24 | Yukihiko SHIMATANI, Kotaro SHIGEMATSU, Shinya IKEMATSU, Jun NISHIHIRO, Yôichi KAWAGUCHI | Seed spraying dispersal by a flooding water in the a restored floodplain |
| O-25 | Yôichi KAWAGUCHI, Natsuki HISAOKA, Takahiro FUKUZAKO, Kichan PARK, Yukihiko SHIMATANI | Fish abundance and stream habitat relationships in urban stream, Kyushu, Japan |

4. Technology for ecological restoration [Chaired by Kim N.C. & Imanishi J.] / Room Mizudori

- O-26 Yihe LU, Bojie FU, Liding CHEN Performance assessment for ecological rehabilitation of the Loess Plateau landscapes: theory and application issues
- O-27 Liliya DIMEYEVA, Natalia OGAR Rehabilitation of salt deserts in the Aral Sea coast
- O-28 Masafumi ITO, Junzo SAGO, Kazumasa ITO, Susumu DOMON Approach for international exchange of river restoration technology
- O-29 Hitoshi SAKIO Restoration of riparian forest in upper basin
- O-30 Juyoung LEE, Eijiro FUJII Different gap effects on two restored forests with structural heterogeneity
- O-31 Satoshi ITO, Makoto NAKAYAMA, Yoko ADACHI, Aya NISHIWAKI Evaluation of a revegetation technique using seedbank contained in topsoil on a newly constructed riverbank of the Chino River, southern Japan
- O-32 Nam-Choon KIM, Ho-kyung SONG, Joon-Woo LEE, Bon-hak KOO, Seok-Ki MOON, Dae-Hyun CHA, Sang-Joon NAM The experimental study on the ecological revegetation methods of the water fluctuated slopes in dam reservoir in Korea
- O-33 Junichi IMANISHI, Akiko SUZUKI, Ayumi IMANISHI, Yukihiko MORIMOTO, Tomomi FUJITA Greenery on vertical walls: lessons from Biolung in Expo 2005, Aichi, Japan
- O-34 Chang-Seok LEE, Y. C. CHO, H. C. SHIN, S. M. LEE An evaluation on the effects of rehabilitation practiced in the coal mining spoils in Korea

17 (Saturday) 9:45 – 12:30

5. Monitoring and evaluation of habitats [Chaired by Natuhara Y., Peng S. & Morimoto J.] / Room Sei-un

- O-35 Daniel CHONGO, Ryota NAGASAWA Fire monitoring in savanna ecosystems using MODIS data: A case study in Kruger National Park, South Africa
- O-36 Atsuko NONOMURA, Takuro MASUDA, Hitoshi MORIYA Vegetation recovery monitoring after wildfire using GIS and remote sensing
- O-37 Noritoshi KAMAGATA, Masaru MORI, Yukio AKAMATSU, Yunqing LI, Keitarou HARA Object-based classification of high resolution satellite data for landscape monitoring
- O-38 Junko MORIMOTO, Futoshi NAKAMURA, Takehiko KATSUNO Trial of broadening parameters detecting the potential habitat area of *Rhododendron* section *Brachycaryx* using remote sensing data and DEM
- O-39 Liu YANG, Ke-Ming MA, Qing-Hai GUO Regional urbanization and the impacts on runoff and pollutant production: a modeling approach
- O-40 Shaolin PENG, Yuping HOU, Baoming CHEN Vegetation Restoration and its effect on Carbon Balance in Guangdong Province, China
- O-41 Yuxin ZHANG, Keming MA, Madhur ANAND, Bojie FU Universal scaling laws of species diversity: a multifractal study
- O-42 Yoshihiro NATUHARA Site evaluation methods for ecosystem restoration
- O-43 Akiko YANAI, Keiichi OHNO Landscape ecological studies on structural analysis of green patches occurring in urban areas

6. Management of rural ecosystems and biodiversity 2 [Chaired by Nakamura K., Storozhenko S.Y., Shibata S. & Sakamoto K.] / Room Gekko-1

- O-44 Shozo SHIBATA, Nobu KURODA, Akira KITA Change of forest landscape in Kitayama forestry area, Kyoto, Japan
- O-45 Hitoshi MATSUMOTO, Tamotsu HATTORI Management of Satoyama -Present and Future-
- O-46 Samang HOMCHUEN, Phetprakai WONGSORN, Yasushi SASAKI Community forest as a tool for integrating biodiversity conservation and sustainable use in northeastern Thailand
- O-47 Atsuo MORIMURA A landscape model of satoyama and its simulation: from a case study of Okazaki Eco-education Forest
- O-48 Ayako IWASAKI, Hiroaki T. ISHII Edge effects, invasive species and ecological restoration in fragmented shrine forests in southern Hyogo Prefecture, Japan
- O-49 Ramadhani Eka PUTRA, Koji NAKAMURA Effect of Satoyama paddy fields restoration on local pollination system
- O-50 Chun-Yen CHANG, Yen-Yu CHOU A landscape ecological approach to the relationship between hedgerow corridors and avian in rural area of Taiwan
- O-51 Toyohiko KIROKO, Yuichiro FUJITA Environmental change in the abandoned paddy field
- O-52 Atsushi SHOJI Toward the restoration of semi-natural grassland in Aso, western Japan
- O-53 Keiji SAKAMOTO, Norikazu YAMANAKA, Guosheng ZHANG, Yoshiaki ISHII, Naoko MIKI, Ikuo NINOMIYA, Linhe WANG, Ken YOSHIKAWA Regeneration process of *Sabina vulgaris* Ant. in the Mu Us Sandland, Inner Mongolia, China

7. Management of watershed and wetland [Chaired by Kim K.G., Nakamura F. & Kadono Y.] / Room Gekko-2

- O-54 Wei-Hong ZHU, Ying NAN, Kwi-Gon KIM, Junichi IMANISHI, Yukihiro MORIMOTO Characteristics of the spatial distribution of wetlands in Tumen River lower stream area
- O-55 Futoshi NAKAMURA, Takashi ONO, Satoshi KAMEYAMA, Yoko NAKATANI, Masami KANEKO Landscape analysis of forest expansion in the Kushiro Mire with special reference to flooding and groundwater level
- O-56 Izumi KATANO, Yôichi KAWAGUCHI, Tomoko MINAGAWA, Takashi TASHIRO, Yuichi KAYABA Effects of a tributary inflow on the benthic macroinvertebrate assemblages in the downstream of the Agi-gawa dam: seasonal comparison between summer and winter
- O-57 Mayumi TAKAHASHI, Yasuhiro TAKEMON, Futoshi NAKAMURA Effects of forested and unforested riparian zones on benthic invertebrates in a mountainous river system in Japan
- O-58 Hiroyuki YAMADA, Kenta TAMAI, Toshikazu KIZUKA Effects of agricultural landuse on distribution of freshwater fish in mire pools of the Ishikari peatland, northern Japan
- O-59 Toshikazu KIZUKA, Hiroyuki YAMADA, Masao YAZAWA Effects of agricultural landuse on water quality in mire pools of the Ishikari peatland, northern Japan

O-60	Kentaro YUTANI, Norio TANAKA, K.B.S.N. JINADASA, Thidar AYE	Effect of dead culm on radial oxygen loss of <i>Phragmites australis</i> under different light intensities and temperature
O-61	Masahiro HORIKAWA, Yoshihiro NATUHARA, Yukihiko MORIMOTO	Study of wetland ecosystem with pelicans for prospective Aral Sea restoration
O-62	Vicente SANTIAGO-FANDINO	What is "Phytotechnology"?

8. Policy and public involvement [Chaired by Nishihiro J. & Kobayashi T.] / Room Mizudori
--

O-63	Wataru SUZUKI	Nature restoration programs of the Ministry of the Environment of Japan
O-64	Tatsuaki KOBAYASHI, Noboru KURAMOTO, Yoshihiko TSUMURA	Proposal of biodiversity-cared policy of revegetation technology
O-65	Hai REN	Degraded ecosystem and its restoration in China
O-66	Xue BAI, Keming MA	The economics in biological conservation
O-67	Adcharaporn PAGDEE, Yasushi SASAKI	Ecological economic factors influencing the success of community forest management - the case of Dong Yai, northeast Thailand
O-68	Mayumi HAYASHI	Sustainable management with citizen participation of natural resource in Awaji Island Park
O-69	Iwao MIYOSHI, Katsue FUKAMACHI, Mariko OHGISHI	Assessment from a cultural viewpoint of river management in a mountainous area on the Tango Peninsula
O-70	Mio HORIUCHI, Katsue FUKAMACHI, Hirokazu OKU, Shozo TERAOKA	Reed community restoration projects involving satoyama resources in the Lake Biwa area
O-71	Mitsuru ABE	Halophyte habitat and channel planning of the Aiwari River in Kitakyusyu, Japan

Poster Session

16 (Friday) 13:30 – 17:00

Core time for the presentation

Group I: 13:40-14:30, Group II: 14:40-15:30, Group III: 15:40-16:30

Ecological Restoration (ER)

I	P-1	Hiromi YAMAGAWA, Satoshi ITO	Restoration of natural forests from conifer plantations: with special reference to biological legacy
II	P-2	Daisuke HOSOGI, Katsue NAKAMURA, Akira KAMEYAMA	Revegetation on an artificial cut slope using forest topsoil with growth material spraying method
III	P-3	Tadashi MASUZAWA, Ryuuichi SEKOGUCHI, Ken-ichi MATSUBAYASHI, Hajime ISE	Predicting suitable habitat of the ptarmigan (<i>Lagopus mutus</i>) for conservation planning.
I	P-4	Jeung-hyun KOH, Toru UEDA, Yukihiro MORIMOTO	A comparative study by soil seed bank for ecological restoration in a constructed area
II	P-5	Takumi AKASAKA, Hisashi YANAGAWA, Futoshi NAKAMURA	Use of bridges as day roost by bats in rural area
III	P-6	ZhanFeng LIU, BoJie FU, GuoHua LIU, HuiFeng HU, YaQiong WU	Soil microbial community changes along a restoration chronosequence in pine plantation in Southwest China
I	P-7	Fuyuki TAZAKI, Yuriko ANDO, Taizo UCHIDA, Junkoh MARUYAMA	Environmental factors for <i>Ranunculus nipponicus</i> var. <i>submersus</i> transplantation
II	P-8	Masanobu YAMANE, Hiroshi SASAKAWA, Tsuyoshi YOSHIDA, Tamotsu AMEMIYA, Toru SUZUKI, Keitaro HARA	Developing GIS based information system for participatory local nature restoration project: a case study on Tanzawa Mountains, Kanagawa, Japan
III	P-9	Kunio UEMURA	The habitat conservation of Yasha-gengorou (<i>Acilius kishii</i> NAKANE)
I	P-10	Anand Narain SINGH	Ecological engineering as a modern tool for restoration of degraded lands: a case study of coal mine spoil in dry tropical region of India
II	P-11	Shaolin PENG, Hongfang LU, Yuping HOU, Longsheng YU, Baoming CHEN, Guanfeng LIANG	Research on the benefits and mechanism of vegetation restoration in the two sub-islands of Macao

Vegetation and Landscape Ecology (VE)

III	P-12	Ryota NAGASAWA	Methodological discussion on GIS-based vegetation mapping
I	P-13	Gang LIAN, Xudong GUO, Bojie FU, Chenxia HU	Spatial variation and prediction of soil properties by using environmental variables on catchment scale in the loess hilly area, China

II	P-14	Huifeng HU, Guohua LIU, Bojie FU	Changes and characteristics of soil organic carbon along the chronosequences of <i>Pinus</i> plantation in Southwest China
III	P-15	Yutaka IWASAKI, Tsuyoshi YOSHIKAWA, Michiro FUJIHARA	Allelopathic effects of <i>Senecio madagascariensis</i> Poiret on germination and initial growth of revegetation plants
I	P-16	Taizo UCHIDA, Teruo ARASE, Fuyuki TAZAKI	Weed risk assessment of exotic grasses (Poaceae): evaluation based on cloning from their stem segments
II	P-17	Toshihiro SUGIURA, Emi OCHIAI, Mitsuhsa BABA, Hiroshi KOBAYASHI	Vegetational characteristics of microhabitat in an endangered grassland bird species - the Japanese Marsh Warbler
III	P-18	M. Abdul MALEQUE, Hiroaki ISHII, Kaoru MAETO, Shingo TANIGUCHI	The importance of line thinning toward ecosystem management in Japanese cedar (<i>Cryptomeria japonica</i> D. Don) plantations, central Japan
I	P-19	Ken YOSHIKAWA, Yasuhito YAMAGUCHI, Yoshihiro YAMADA, Naoko MIKI	Eco-physiological adaptability of <i>Caragana microphylla</i> , xerophyte growing in Mongolian Gobi-steppe, to environmental variation
II	P-20	Ryuichi TACHIBANA, Ichio NIOH, Kenji FUKUNAGA, Takehiko OHTA	Influence of soil physical and chemical characteristics on soil microbiota in the revegetation slopes
III	P-21	Shinya ISHIDA, Tomohiko KAMITANI, Tohru NAKASHIZUKA	Effects of fluvial and artificial fire disturbances on the occurrence of plant species in a major bed of Shinano River
I	P-22	Keisuke OBASE, Yoganath ADIKARI, Takashi YAJIMA, Yutaka TAMAI, Toshizumi MIYAMOTO	Primary vegetation recovery after the 2000 eruption on the volcano Usu, Hokkaido, Japan.
II	P-23	Kazutoki ABE, Ushio KUROKAWA	Changes of the forested slope stability after clear logging and thinning
III	P-24	Yoshio SASAKI, Yukihiko MORIMOTO	The succession of the coastal vegetation of Tottori Sand Dune in Japan.
I	P-25	Yoriko HATASE, Hitomi OGURI, Masahiko MATSUE, Etsuko UTSUGI, Ikuko IMOTO	A restoration experiment on forest floor vegetation at Michinoku Lakewood National Government Park in the Fagetea crenatae region, Tohoku district, Japan
II	P-26	Mitsuaki MATSUURA, Tatsuaki KOBATASHI	The relation between plant species composition and vegetation management with coppicing in secondary forest of <i>Quercus serrata</i> in a Tokyo metropolitan park in Sayama Hill, Japan
III	P-27	Yoshiyuki HIOKI, Rie SUGAI	Evaluation of restoration possibility of <i>Fagus crenata</i> forest which replaced by <i>Cryptomeria</i> plantation forest in East Chugoku Mountain Area, Japan
I	P-28	Junichiro YOKOTA, Yoshiyuki HIOKI	Gap Analysis and monitoring of important plant communities in Tottori Prefecture, Japan
II	P-29	Atsushi NAKASHIMA, Masanori YAMAMOTO, Naomi YOSHIDA	Effects of year round warming on the growth and phenology of some temperate tree species
III	P-30	Toru SUZUKI, Masanobu YAMANE, Hiroshi SASAKAWA, Tsuyoshi YOSHIDA, Keitaro HARA	Evaluation on the impact of deer overabundance in developing the ecosystem management strategy

I	P-31	Chiaki SUZUKI, Masashi NOMURA, Tatsuaki KOBAYASHI Tsuayoshi YOSHIDA, Sho SUGIMURA, Hiroshi SASAKAWA,	Genetic variation and structure in the endangered plant <i>Rhododendron dilatatum</i> (Ericaceae)
II	P-32	Masanobu YAMANE, Toru SUZUKI, Norihisa TANAKA, Keitaro HARA	Landscape-scale assessment of exotic plant invasions in the Tanzawa Mountains
III	P-33	Aya NISHIWAKI, Kumiko OKADA, Akira KAIHARA, Yota SAKAI, Aki MIZUGUTI	Invasive plant control by facilitate the competitive native plant: Biological control of <i>Solidago altissima</i> by <i>Imperata cylindrica</i>
I	P-34	Akihiro NAKAMURA, Maiko SHIOTA, Keisuke KADOYA	Effects of temperature fluctuation, water potential and litter on seed germination and emergence of 15 woody species.
II	P-35	Keigo YAMASHITA, Yosuke KATO, Hiromune MITSUHASHI, Mahito KAMADA Michiko MOTOE, Michiro	Risk assessment of landslide occurrence in the region of monotonous cedar plantation for setting priority of nature restoration
III	P-36	FUJIHARA, Satoshi YAMAMOTO, Takashi OYABU, Nobuyuki MINO, Shozo SHIBATA	Management of bamboo stands based on estimation of range expansion bamboo stands in Awaji Island
I	P-37	Shigeharu KOGUSHI, Mahito KAMADA	Predicting potential unsuitable site for <i>Sasa</i> growing -the core for restoring endangered grassland plants
II	P-38	Kazuya ASHIZAWA, Noboru KURAMOTO	Distribution and habitat of chasmophyte, <i>Spiraea thunbergii</i> , along the River Tama
III	P-39	Shingo KUSAKA, Tatuo KIRA	Regeneration of burned <i>Larix sibirica</i> forest in Lake Hovsgol watersheds of northern Mongolia; Field experiment on inhibiting factors of regeneration
I	P-40	Katsuyuki TANAKA, Wataru KATO, Yuya OHORI, Eikichi SHIMA, Toshihiro SUGIURA, Toshihiro HATTORI, Hiroshi SHIMADA, Jyun-ichi TAKEDA	Estimation of the grassland management information using remote sensing
II	P-41	Yaqiong WU, Guohua LIU, Bojie FU, Huifeng HU, Zhanfeng LIU	Comparing soil respiration in pine plantation and oak shrub: dynamics and correlations

Policy and Public Affairs (PP)

III	P-42	Chun-Yen CHANG	Recreation activity impacts on the ecotourism sites in Taiwan
I	P-43	Chen-Xia HU, Bo-Jie FU, Li-Ding CHEN, Hubert GULINCK Noboru KURAMOTO, Hajime KOSHIMIZU, Satoshi TADA,	Farmer's attitudes towards Grain-for Green program in the Loess hilly area, China
II	P-44	Akihiko KANO, Miwa MOCHIDA, Yuko HATORI, Tomoyo KOYANAGI, Yoko KOGA	Experiment on conservation education using proposed university farm and surrounding Satoyama
III	P-45	Hirokazu OKU, Nahoko OGAWA, Mio HORIUCHI, Katsue FUKAMACHI	Landscape and ecology of bamboo grass-thatched roofs on the Tango Peninsula, Japan
I	P-46	Hideyuki IDA, Aya GOTO	Traditional sustainable forest management for a rural landscape receiving heavy snowfall

II	P-47	Toshiyuki TAKASUKA	Nature restoration in national parks in Japan
III	P-48	Tomoyasu YOSHITOMI, Kenichi MASAKI	Trends in displays and environmental interpretation for water environments and related facilities in Japan.
I	P-49	Hana JEON, Byungseol BYUN, Hyeyoung NA	Sustainable waterfronts development for residents at coastal area
II	P-50	Hyeyoung NA, Byungseol BYUN, Hana JEON	Analysis of historical landscape assets to improve city image
III	P-51	Satoshi YAMAMOTO, Yutaka IWASAKI	Effects on greenery landscape viewing on stress reduction in terms of human physiological changes
I	P-52	Atsushi YAMABA, Sonoko WATANABE, Shuji WADA	Forest ownership pattern impacting on landscape structure of vegetation in a mountainous farm village
II	P-53	Keiichi SUGIYAMA	Publications of Association for Nature Restoration and Conservation, Japan
III	P-54	Mariko KATSUSE, Michiro FUJIHARA, Satoshi YAMAMOTO, Takashi OYABU	Landscape ecological study on a working holiday for conservation of rural area

Rural Ecology (RE)

I	P-55	Masa-aki MAEKAWA	How the ringbarking method is effective to regeneration and ecological conservation of rural forested landscape in Japan ?
II	P-56	Tatsuaki KOBAYASHI, Hitomi MURASE, Yohei KAMIYAMA, Terumasa TAKAHASHI	Functional analysis of soil-flora relationship through the stop and renewal of suburban forest management with special reference to nitrate dynamics
III	P-57	Hiroki ITÔ	Changes in a secondary forest located in Kyoto City, mid-west part of Japan
I	P-58	Akemi ITAYA, Masami SHIBA, Naoyuki NISHIMURA, Nobuhiro TOMARU, Shin-Ichi YAMAMOTO	Extraction of past forest canopy composition for landscape restoration by object-oriented image analysis using aerial photographs
II	P-59	Shigeo SUZUKI, Nobukazu NAKAGOSHI	Expansion of <i>Phyllostachys pubescens</i> forest by decline of bamboo-shoots herbes production and its operating location factors
III	P-60	Seiya ABE, Makoto NASHIMOTO, Rikyu MATSUKI, Toru TAKEUCHI	Predictive mapping of ground vertebrate fauna in the costal area of Japan
I	P-61	Jun NEMOTO, Atsushi NAKASHIMA, Shiro NAKAO	Studies on the invasions of non-native garden tree species to fragmented secondary stands of <i>Quercus serrata</i> in a suburban district
II	P-62	Young Bok CHO	Diversity of Staphylinidae (Insecta, Coleoptera) as potential bioindicators in Korean satoyama
III	P-63	Naoshige ABE, Yoshio YAMAOKA, Hitoshi OGAWA, Hirotohi TAKAZAKI	Preservation method of hometown forests using goat pasture. Influence of short-term first year pasturing, reduced highly bamboo mass and weed
I	P-64	Hitoshi OGAWA, Hirotohi TAKAZAKI, Naoshige ABE	Preservation method of hometown forest using goat pasture. Influence of short-term second year pasturing, induced highly bamboo and weed growth
II	P-65	Hirotohi TAKAZAKI, Hitoshi OGAWA, Naoshige ABE	Preservation method of hometown forest using goat pasture. Non-pastured effect of bamboo and weed growth in the third year

III	P-66	Wei WEI, Liding CHEN, Bojie FU, Zhilin HUANG	The effect of land use and rainfall patterns on runoff and soil erosion in the semi-arid loess hilly area, China
I	P-67	Tae-Young CHOI, Chong-Hwa PARK	Which is better type for mammal passage across rural highway in Korea, box or pipe?
II	P-68	Hyu-Soo KWON, Chong-Hwa PARK, Tae-Young CHOI	Factors affecting raccoon dog mortality on a rural highway in Korea
III	P-69	Liliya DIMEYEVA, Valeriya PERMITINA, Vladimir MERKOURIEV	Ecological restoration of degraded lands at the oil fields in the Eastern Caspian region

Urban Restoration (UR)

I	P-70	Yoshitaka OOISHI, Keizo TABATA, Hiroshi HASHIMOTO, Yukihiro MORIMOTO	Epiphyte bryophytes diversity at fragmented forests in Kyoto City
II	P-71	Ayumi IMANISHI, Chieko KITAGAWA, Susumu NAKAMURA, Hiroshi HASHIMOTO, Keizo TABATA, Junichi IMANISHI, Yukihiro MORIMOTO, Mifumi MIYAMOTO	Changes in herbaceous plants at an urban ecological park for 9 years after construction
III	P-72	Li-hong ZHANG, Jian LIU, Shu-hua LI, Fei WU	The effect of pavement percentage to urban green space's temperature and humidity
I	P-73	Pham Duc UY, Nobukazu NAKAGOSHI	Study landscape fragmentation and connectivity on eco-network based on urban green spaces in Hanoi, Vietnam: an application of graph theory
II	P-74	Takeshi SASAKI, Yukihiro MORIMOTO, Junichi IMANISHI	Monitoring of the forested area in Expo'70 Park for 30 years after reclamation
III	P-75	Hiroshi HASHIMOTO, Junichi IMANISHI, Takeshi SASAKI, Yukihiro MORIMOTO, Takafumi TANAKA, Yoshimichi SENDA, Naohiro UKAI, Katsunori KITADA	Evaluating airborne laser scanners as a tool for detecting stratification of urban forests
I	P-76	Ryou OHTAGAKI, Yoshiyuki HIOKI	Evaluation of green shade effect of trees by using thermo graph
II	P-77	Terumasa TAKAHASHI, Yoshiaki KANZAWA, Norihiko NISHIO, Tatsuaki KOBAYASHI	Effects of urbanization on chemical characteristics of forest soil along Tamagawa river in Tokyo, Japan
III	P-78	Keizo TABATA, Hiroshi HASHIMOTO, Yukihiro MORIMOTO, Hisayuki MAENAKA	A simulation model of tree population dynamics of urban forest in kyoto city, using tree growth, mortality and recruitment rate as parameters
I	P-79	Norihiko NISHIO, Aya WATANABE, Terumasa TAKAHASHI, Tatsuaki KOBAYASHI	Effects of urbanization on organic matter dynamics in forest soil along Tamagawa river in Tokyo, Japan
II	P-80	Takatsuna KURODA, Takehiko KATSUNO	Analysis of the relationship between habitat of small mice and land use in urban green areas

III	P-81	Kentaro MURAKAMI, Fumiyoshi UWAKUBO	Relationship between woody plant species diversity and patch area in fragmented woodlots in shrines and temples, Kishiwada City, southern Osaka Prefecture, Japan
I	P-82	Jae-cheol KIM, Hyo-Jin LEE, Dong-hoon SHIN, Kyoo-seock LEE	Identifying urban heat island decreasing effects by urban stream
II	P-83	Moriyasu OTSUKA	Namba parks “Parks Garden”: Create woods in the center of a metropolitan.
III	P-84	Tatsuji NISHIO	The grand design for urban environmental infrastructure in Tokyo Metropolitan Area and the issue on green tract preservation

Watershed Restoration (WR)

I	P-85	Masayuki TAKADA, Toru SUZUKI, Aosier BUHE, Katsumi TAMADA, Shosuke NATSUME	Habitat analysis of grassland birds using remote sensing and GIS technique in Sarobetsu mire, Japan
II	P-86	Satoshi OSAWA, Takehiko KATSUNO	Distribution of the vulnerable plant species <i>Ludwigia peploides</i> in urban river and the conservation plan for the river dredging work. central Japan
III	P-87	Kaori KOCHI, Seiji YANAI, Yoshio MISHIMA, Toshikazu TAOKA	Movement and decomposition of salmon carcass, and its effects on natural stream ecosystem in central Hokkaido, northern Japan.
I	P-88	Chihiro YOSHIMURA, Takanori WATANABE	Relationship between flow regime and species richness of fish in major Japanese rivers
II	P-89	Asami OGURA, Kazuhiko TAKEDA, Takayuki NAKATSUBO	Causes of long-term changes in BOD in an urbanizing river basin
III	P-90	Yu HAGIMORI, Akiko SASAKI, Takayuki NAKATSUBO	Effects of tidal levels on aerobic decomposition in an intertidal estuary in Japan
I	P-91	Wataru KAKINO, Masakazu MIZUTANI	Distribution of <i>Nisematsukasagai (Inversium reinianus yanagawensis)</i>
II	P-92	Estuko HARADA, Hiroyuki FUKAWA, Makoto OGAWA, Kazuo YOSHIDA, Hiromune MITSUHASHI, Mahito KAMADA	Classifying wetland habitat by predicted occurrence pattern of hygrophyte – damselfly functional group
III	P-93	Yasuto FUKUOKA, Mahito KAMADA, Hiroshi TAKEBAYASHI, Takeshi OKABE	Can flood control invasive grass, <i>Eragrostis curvula</i> , at gravel bar? -Lesson from the cases in the Yoshino River, Shikoku, Japan
I	P-94	Yukiko KATAGIRI, Satoshi OSAWA, Hideya YAMASHITA, Mikiko ISHIKAWA	Evaluation method for the habitat potentialities by small watershed, in the southern part of the Tama hills, central Japan
II	P-95	Seiji YANAI, Tomotoka KATO, Masayuki TAKADA	Land use influences on water quality and lake ecosystems in eastern Hokkaido, Japan.
III	P-96	Kazuto SHIMA	Nitrogen loss through leaching and surface runoff on the wild fire affected slope
I	P-97	Tomoko MINAGAWA, Satoshi FUKUSHIMA, Takashi TASHIRO, Yuich KAYABA	Effects of artificially augmented discharge on periphytic algal communities in a regulated river (River Nakatsu, Japan)

II	P-98	Michiko SHIMODA, Hisanori KAGAWA	Effective management for the conservation and recovery of aquatic flora diversity in irrigation ponds
III	P-99	Motoki HIGA, Arimichi MOROI, Keiichi OHNO	Environmental characteristics of safe sites for riparian tree species at spur dyke in Kiso river, Central Japan
I	P-100	Yoshiyuki ISOZAKI, Akira KIKUCHI, Daisuke SAITOH, Nobukazu NAKAGOSHI, Tomohisa NAGATA, Akira SAKAMURA, Wataru YAMAZAKI	Presumption of source of eutrophication by landscape analysis in a case of Haji Dam watershed
II	P-101	Akira KIKUCHI, Yoshiyuki ISOZAKI, Nobukazu NAKAGOSHI, Shigeo SUZUKI	Multiscale landform classification study of the Haji Dam watershed, south western Japan
III	P-102	Daisuke SAITOH, A.KIKUCHI, T. TAO, M. SIMADA, Y. ISOZAKI, N. NAKAGOSHI, T. NAGATA, A. SAKAMURA	Difference in suspended matter at each period of rainy season for phosphorus concentration level: a case study in Gōno River watershed in Hiroshima Prefecture
I	P-103	Takashi TASHIRO, Izumi KATANNO, Yuichi KAYABA, Koji HASEGAWA, Yoshihiko NITTA, Tomoko MINAGAWA	Physical habitat of the endangered catfish <i>Pseudobagrus ichikawai</i> in a natural section in the western part of Tokai District, Japan
II	P-104	Shirou AYA, Hajimu KIHARA	Restoration of river environment, Kuzuha, The Yodo River
III	P-105	Satoquo SEINO	Problems and perspectives of ecological engineering and social systems in coastal protection and restoration at river mouths and tidal flats in Japan
I	P-106	Farzin ESKANDARI	Analysis of hazardous bacterial agents on the processing of <i>Artemia urmiana</i> cysts and biomass by using of HACCP principal
II	P-107	Kisho TAKASHIMA, Hiroshi HAMAGUCHI, Toru UEDA, Fujiyoshi SHIBAHARA, Etuji HAMAHATA	Potential of seed bank in sublacustrine soil on shores of Lake Biwa
III	P-108	Yo MIYAKE, Hironune MITSUHASHI, Tsuyoshi AKIYAMA	Effects of catchment characteristics on habitat environment and community structure of stream invertebrates
I	P-109	Takeshi FUJINO, Takashi ASAEDA, Takashi NAKAJIMA, Aung NANDA	Effect of floodplain on CPOM transport in 2nd order stream
II	P-110	Aung NANDA, Takeshi FUJINO, Takashi ASAEDA, Yoichi TAKAHASHI	Macro-invertebrate community composition in upstream & downstream to the Takizawa dam
III	P-111	Kian SIONG, Takashi ASAEDA, Takeshi FUJINO	Difference characteristics of phosphorus in Chara and two submerged angiosperm species: Implications for phosphorus nutrient cycling in an aquatic ecosystem
I	P-112	Takayoshi TSUZUKI, Mahito KAMADA, Tokushima Office of River and National Highway	Policy and measures against rapid invasion of weeping lovegrass in the Yoshino River, Shikoku, Japan

Open Symposium / Room Gekko

17 (Saturday) 13:30 – 17:00

Nobukazu NAKAGOSHI, Sonoko WATANABE	Recovery of green resources in Hiroshima City after the World War II
Giovanni SANESI, Raffaele LAFORTEZZA, Pasquale MARZILIANO	Assessing the current status of urban forest resources in the context of “Parco Nord”, Milan, Italy
Alice SHARP, Nobukazu NAKAGOSHI	Rehabilitation of degraded forests in Thailand: policy and practice
Hou-Nan TSAI	Strategy and Policy of National Territory Restoration in Taiwan
Bo-Chul WHANG, Myung-Woo LEE	Landscape ecological planning principles in the Korean Feng-Shui, Bi-bo woodlands and ponds
Yukihiro MORIMOTO	Role of the EXPO'70 forest project in the development of forest restoration in urban areas

Excursion

18 (Sunday) 9:00 – 16:30

Post conference excursion will be arranged to visit the reforested sites in the Expo Park adjacent to the venue in the morning and 4 other sites in the afternoon on 18 June. Excursion cost is included in the registration fee. But participants are requested to announce your participation and your selected course by e-mail as soon as possible but not later than April 15.

Course 1: Reforested site in the Expo Park, (AM only)

Course 1 starts at 9:00 at Expo Park and will end at 12:00 Expo Park.

No limitation number of participants.

Course 2: Reforested sites in the Expo Park (AM) and Japanese garden in the Expo Park (PM)

Course 2 starts at 9:00 and will end at 16:00 at Expo Park.

No limitation number of participants.

Course 3: Reforested sites in the Expo park (AM) and Developing new town (PM)

Course 3 starts at 9:00 at Expo Park and will end at 16:30 at Senri-chuou Station*.

Maximum of 50 participants.

Course 4: Reforested site in the Expo Park (AM) and Osaka Nanko Bird Sanctuary (PM)

Course 4 starts at 9:00 at Expo Park and will end at 16:30 at Suminoe-Koen Station*.

Maximum of 25 participants.

Course 5: Reforested site in the Expo Park (AM) and Namba Parks (PM)

Course 5 starts at 9:00 at Expo Park and will end at 16:30 Namba Parks*.

Maximum of 25 participants.

* It takes about 90 min from Senri-Chuou station, 75 min from Suminoe-Koen station and 60 min from Namba parks to Kansai International Airport.

Expo park, Reforested site (on foot, AM)

<http://www.expo70.or.jp/e/index.html>

After Expo '70, the site was converted into natural and cultural gardens, which had spacious lawn area, forests, Japanese garden and a museum. One of the objectives of forestation was to create sustainable forests that had biodiversity and regeneration. The large part of the forests was designed to have evergreen species that consisted the climax species in this region. About 30 years from plantation, almost forests were established and had high stand density. To enhance the biodiversity of closed forest, a part of the forests were thinned and the monitoring the effects. You will find the landscape of planted urban forest and vegetation, and feel the effects of restoration program for biodiversity.

Expo park, Japanese Garden (on foot, PM)

<http://www.expo70.or.jp/e/index.html>

The Japanese Garden, consisting of 26 hectares of land provided to Expo '70 as a government exhibit, is a renowned garden of the Showa Period and a prime example of Japanese landscaping technique. Built alongside a stream that runs from west to east, four periods in the history of Japanese landscaping are represented here, creating a luxurious walking course where visitors lose track of time as they drink in the delicate beauty of the Japanese aesthetic. The garden design incorporates representations of the path of mankind--and the progression of time--using flowing water, and also strikes a perfect balance as a whole.

Developing new town area containing secondary forests in urban Osaka (by bus, PM)

<http://www.pref.osaka.jp/minoh/index.html> (Japanese only)

A new residential town called "Healthy city with water and green environment" is now under construction in hilly area in northern Osaka. Most of planned area was a secondary forest where coppiced management was carried out about 20 years ago. One of the concepts of this new town is to realize a society with harmonious coexistence between human beings and nature. Prefecture government and citizens had already performed reforestation, forest management conservation and restoration of rare species. You will observe natural vegetation of secondary forest and find the landscape under city construction and ecological restoration site.

Osaka Nanko Bird Sanctuary and greening in port area (by train, PM)

<http://www.osaka-nankou-bird-sanctuary.com/>

The Osaka Nanko Bird Sanctuary was established on the reclaimed land in 1983 by the City of Osaka, and has been managed by the Port and Harbor Bureau. A lot of shore birds are visiting this site now. However this sanctuary was not accomplished easily. You can learn the history of the park and an essence of adaptive management in this site. Some other attempts for greening in a port area will be visited.

Namba Parks (by train, PM)

<http://www.nambaparks.com/index2.html> (Japanese only)

Namba Parks was constructed at the site after the Osaka's baseball stadium closed its doors as a redevelopment to a new commercial district adjacent to Namba Station. Rooftops (10,000m²) of the Namba Park's buildings are greened and providing a highly visible green component in a city where nature is sparse. Visiting people enjoy its groves of trees, clusters of rocks, cliffs, lawn, streams, waterfalls, ponds and outdoor terraces. Namba Parks creates a new natural experience for a big city. You will find new technologies of greening on artificial ground and rooftop gardening.

List of Participants

242 participants from 12 regions will gather to the Conference

Name		Affiliation		Presentation		Excursion	Banquet
ABE	Kazutoki	Nihon university, college of bioresource sciences	Japan	P- 23		No	Yes
ABE	Mitsuru	Planning Division, Foundation for Riverfront Improvement and Restoration	Japan	O-71		No	No
ABE	Naoshige	College of Agriculture., Univ. of Tamagawa	Japan	P- 63	P- 64, P- 65		
ABE	Seiya	Central Research Institute of Electric Power Industry	Japan	P- 60		No	Yes
AKAISHI	Daisuke	Graduate School of Natural Science and Technology, Kanazawa University	Japan	O-12		Yes	No
AKASAKA	Takumi	Department of forest Science, Graduate School of Agriculture, Hokkaido University	Japan	P- 5		Yes	No
ASAEDA	Takashi	Department of Environmental Science, Saitama University	Japan	O-18	P-109, P-110, P-111		Yes
ASHIZAWA	Kazuya	Fac. of Agri., Meiji Univ.	Japan	P- 38		No	No
AYA	Shirou	Department of Civil Engineering and Urban Design, Osaka Institute of Technology	Japan	P-104		Yes	Yes
BAI	Xue	Key Lab. of Systems Ecology, Research Center for Eco-Environmental Sciences, Chinese Academy of Sciences	P. R. of China	O-66		Yes	No
BOGAERT	Jan	Université libre de Bruxelles	Belgian	O- 1		Yes	Yes
BYUN	Byungseol	Dept. of Public Administration, Inha University	Korea	O- 6	P- 49, P-50	No	No
CHANG	Chun-Yen	Department of Horticulture, National Taiwan University,	Taiwan	O-50, P-42		Yes	Yes
CHEN	Li-Ding	Research Center For Eco-Environmental Sciences, Chinese Academy of Sciences	P. R. of China	O- 8	O-26, P-43, P-66	Yes	Yes
CHIBANA	Takeyoshi	Dept. of Civil Engineering, Faculty of Engineering, University of Tokyo	Japan	O-21		Yes	Yes
CHIHARA	Yutaka	Commemorative Organization for the Japan World Exposition '70	Japan			No	No
CHO	Young Bok	Natural History Museum, Hannam Univ.	Korea	P- 62		No	No
CHOI	Tae-Young	Seoul National University	Korea	P- 67	P- 68	Yes	Yes

CHONGO	Daniel Azarias	United Graduate School of Tottori University	Japan	O-35		No	No
DA	Liangjun	Shanghai Key Laboratory for Ecology of Urbanization Process and Eco-restoration & Department of Environmental Science, East China Normal University	P. R. of China	O- 2		No	Yes
DAS	Shamal Chandra	Graduate School of Science and Engineering, Saitama University	Japan	O-23		No	No
DIMEYEVA	Liliya	Institute of Botany & Phytointroduction	Kazakhstan	O-27, P-69		Yes	
ESKANDARI	Farzin	Urmia Islamic Azad University,Iran	Iran	P-106			
EZAKI	Yasuo	Inst. Nat. Env. Sci., University of Hyogo	Japan			No	No
FUJIHARA	Michiro	Institute of Natural & Environmental Sciences, University of Hyogo/Awaji Landscape Planning & Horticulture Academy	Japan	O- 4	P-15, P-36, P-54	Yes	Yes
FUJINO	Takeshi	Engineering Ecology Lab., Dept. of Environmental Science & Human Eng., SAITAMA University	Japan	P-109	P-110, P-111	No	Yes
FUKAMACHI	Katsue	Kyoto Prefectural University	Japan		O-69, O-70, P-45	Yes	Yes
FUKAWA	Hiroyuki	Tokushima University	Japan		P- 92	Yes	Yes
FUKUOKA	Yasuto	Graduate School of Engineering, Department of Civil Engineering, The University of Tokushima	Japan	P- 93		No	No
HAGIMORI	Yu	Graduate School of Biosphere Science, Hiroshima University	Japan	P- 90		Yes	Yes
HAMAGUCHI	Hiroshi	The General Environmental Technos Co.Ltd	Japan	P-107		No	No
HARA	Keitarou	Tokyo University of Information Sciences	Japan		O-37, P-8, P-30, P-32	No	Yes
HARADA	Etsuko	Tokushima University	Japan	P- 92		Yes	Yes
HASHIMOTO	Hiroshi	Graduate School of Agriculture, Kyoto University	Japan	P- 75	P-70, P-71, P-78	Yes	Yes
HATASE	Yoriko	Japan Wildlife Research Center	Japan	P- 25		No	Yes
HAYASHI	Mayumi	University of Hyogo	Japan	O-68		Yes	Yes
HENMI	Ichiro	Regional Environmental Planning Inc.	Japan			Yes	No
HIGA	Motoki	Graduate School of Environment and Information Science, Yokohama National University	Japan	P- 99		No	No
HIOKI	Yoshiyuki	Tottori University	Japan	P- 27	P-28, P-76	Yes	Yes
HOMCHUEN	Samang	Department of Environment Science, Faculty of Science, Khon Kaen University	Thailand	O-46		Yes	No
HONG	Sun-Kee	Institute of Islands Culture, Mokpo National University	Korea		O-5, O-6	No	Yes
HORIKAWA	Masahiro	PASCO corporation	Japan	O-61		Yes	Yes

HORIUCHI	Mio	Kyoto University, Graduate School of Agriculture	Japan	O-70	P- 45	Yes	No
HOSOGAKI	Ayaka	Forest Ecology Reserch, the College of Agriculture, Gifu University	Japan			Yes	No
HOSOGI	Daisuke	National Institute for Land and Infrastructure Management	Japan	P- 2		Yes	Yes
HOU	Yuping	Ecology and Evolution Institute Sun Yat-sen University//State Key Laboratory of Biocontrol, School of Life Sciences, Sun Yat-Sen University	P. R. of China		O-40, P-11	Yes	Yes
HU	Chenxia	Research Center for Eco-Environmental Sciences, Chinese Academy of Sciences	P. R. of China	P- 43	P-13	Yes	Yes
HU	Huifeng	Research Center for Eco-Environmental Sciences, Chinese Academy of Sciences	P. R. of China	P- 14	P- 6, P-41	Yes	Yes
ICHIHARA	Satoru	Wakayama University	Japan			Yes	No
IDA	Hideyuki	Institute of Nature Education in Shiga Heights, Faculty of Education, Shinshu University	Japan	P- 46		No	
IMANISHI	Ayumi	Lab. of Landscape Architecture, Graduate School of Agriculture, Kyoto University	Japan	P- 71	O-33	Yes	Yes
IMANISHI	Junichi	Graduate School of Global Environmental Studies, Kyoto University	Japan	O-33	O-54, P-71, P-74, P-75	Yes	Yes
IMOTO	Ikuko	Ryokusei Research Institute Inc.	Japan		P-25	No	Yes
INOUE	Naoko	Commemorative Organization for the Japan World Exposition '70	Japan			No	No
ISE	Hajime	Regional Environmental Planning Inc.	Japan		P- 3	Yes	No
ISHIDA	Shinya	Graduate School of Science and Technology, Niigata University	Japan	P- 21		Yes	Yes
ISOZAKI	Yosiyuki	Hiroshima University : International Development and Cooperation (IDEC) : Nakagoshi Laboratory	Japan	P-100	P-101, P-102	No	No
ITAYA	Akemi	Laboratory of Forest Ecology and Physiology, Graduate School of Bioagricultural Sciences, NAGOYA University	Japan	P- 58		Yes	Yes
ITO	Masafumi	Technical Coordination & Cooperation Division, Foundation for Riverfront Improvement and Restoration	Japan	O-28		No	No
ITO	Satoshi	Faculty of Agriculture, University of Miyazaki	Japan	O-31	P- 1	No	No
ITÔ	Hiroki	Kansai Research Center., Forestry & Forest Products Research Institute, Japan	Japan	P- 57		No	No
IWAMOTO	Hiroshi	Commemorative Organization for the Japan World Exposition '70	Japan			No	No
IWASAKI	Ayako	Kobe University	Japan	O-48		Yes	No
IWASAKI	Yutaka	Lab.of Planting Design ,Faculty of Horticulture,Chiba Univ.	Japan	P- 15	P- 51	Yes	Yes
IWASE	Koji	Biological Environment Institute	Japan	O-16		Yes	Yes

JEON	Hana	Dept. of Public Administration, Inha University	Korea	P- 49	P- 50	No	No
KADONO	Yasurou	Department of Biology, Faculty of Science, Kobe University	Japan			No	Yes
KAKINO	Wataru	Utsunomiya University	Japan	P- 91		Yes	Yes
KAMADA	Mahito	Institute of Technology and Science, The University of Tokushima	Japan		P- 35, P-37, P-92, P-93, P-112	Yes	Yes
KAMAGATA	Noritoshi	Graduate School of Informatics, Tokyo University of Information Sciences	Japan	O-37		No	Yes
KASAGI	Tetsuya	Kakuma-Satoyama Nature School, Kanazawa University	Japan	O-14		Yes	Yes
KASUYA	Emiko	School of Agriculture, Meiji University	Japan			No	No
KATAGIRI	Yukiko	Keio University, Graduate School of Media and Governance	Japan	P- 94		No	No
KATANO	Izumi	Aqua Restoration Research Center	Japan	O-56	P-103	No	Yes
KATO	Wataru	Kitasato University	Japan		P-40	No	No
KATSUSE	Mariko	Awaji Landscape Planning and Horticulture Academy	Japan	P- 54		Yes	Yes
KAWAGUCHI	Yôichi	Kyushu University	Japan	O-25	O-24, O-56	Yes	Yes
KIKUCHI	Akira	Hiroshima University : International Development and Cooperation (IDEC)	Japan	P-101	P-100, P-102	No	Yes
KIM	Hyun Jun	Sung Kyun Kwan Univ., Dept. of Landscape Arch.	Korea			Yes	Yes
KIM	Jae-cheol	Sung Kyun Kwan Univ., Dept. of Landscape Arch.	Korea	P- 82		Yes	Yes
KIM	Jae-Eun	Hiroshima University, Graduate School for International Development and Cooperation	Japan	O- 5		No	Yes
KIM	Jin Hong	Chung-Ang University	Korea	O-22		Yes	Yes
KIM	Kwi-Gon	Seoul National University	Korea	Plenary talk	O-54		
KIM	Nam-Choon	Dankook University, Dept. of Landscape Architecture	Korea	O-32		Yes	Yes
KIM	Yong-sik	Faculty of Natural Resources, College of Natural Resources, Yeungnam University	Korea	Plenary talk			
KIMURA	Kazuya	Institute of Nature and Environmental Technology, Kanazawa University	Japan	O-13		Yes	Yes
KIRA	Tatsuo	Lake Biwa Environmental Research Institute	Japan		P- 39	No	No
KIROKO	Toyohiko	Gifu University Mechanical and Civil Engineering Division	Japan	O-51		Yes	No
KIZUKA	Toshikazu	Research Group of Regional Environment, Graduate School of Agriculture, Hokkaido University	Japan	O-59	O-58	Yes	Yes
KOBAYASHI	Tatsuaki	Faculty of Horticulture, Chiba University	Japan	O-64, P-56	P- 17, P-26, P-31, P-77, P-79	Yes	Yes

KOCHI	Kaori	Hokkaido Institute of Technology	Japan	P- 87		Yes	Yes
KOGUSHI	Shigeharu	The University of Tokushima Department of Civil Engineering	Japan	P- 37		Yes	Yes
KOH	Jeung-hyun	Kyoto University	Japan	P- 4		Yes	Yes
KOSHIMIZU	Hajime		Japan		P-44		Yes
KURAMOTO	Noboru	School of Agriculture, Meiji University	Japan	P- 44	O-64, P-38	Yes	Yes
KURODA	Takatsuna	Graduate School of Bioresource Sciences, Lab. of Landscape Science and Planning, Nihon University	Japan	P- 80		No	No
KUSAKA	Shingo	Lake Biwa Museum	Japan	P- 39		Yes	Yes
KWON	Hyu-Soo	Seoul National University	Korea	P- 68		Yes	Yes
LAMA	Wong Kok	Bright Nepal Pvt. Ltd.	Nepal			Yes	Yes
LEE	Chang-Seok	Seoul Women's University	Korea	O-34		Yes	Yes
LEE	Hyo-Jin	Sung Kyun Kwan Univ., Dept. of Landscape Arch.	Korea		P- 82	Yes	Yes
LEE	Juyoung	Graduate school of science and technology Lab. of landscape planting and technology. Faculty of horticulture, Chiba Univ.	Japan	O-30		Yes	Yes
LI	Shuhua	Department of Ornamental Horticulture and Landscape Architecture, China Agriculture University	P. R. of China		P- 72	Yes	Yes
LI	Xiuzhen	Institute of Applied Ecology, Chinese Academy of Sciences	P. R. of China	Plenary talk		Yes	Yes
LIAN	Gang	Research Center for Eco- Environmental Sciences, Chinese Academy of Sciences	P. R. of China	P- 13		Yes	Yes
LINAWATI		Kanazawa University	Japan	O-11		Yes	No
LIU	Guohua	Research Center for Eco- Environmental Sciences, Chinese Academy of Sciences	P. R. of China		P- 6, P-14, P- 41	Yes	Yes
LIU	Nana	School of Education , Changzhou Institute of Technology in New District Campous	P. R. of China	O-2		No	Yes
LIU	ZhanFeng	Key Laboratory of System Ecology, RCEES, CAS	P. R. of China	P- 6	P- 41	Yes	Yes
LU	Tao	Key Laboratory of System Ecology, RCEES, CAS	P. R. of China			Yes	Yes
LU	Yihe	Key Lab. of Systems Ecology, Research Center for Eco- Environmental Sciences, Chinese Academy of Sciences	P. R. of China	O-26		Yes	Yes
MA	Keming	Research Centre for Eco- Environmental Sciences, Chinese Academy of Sciences	P. R. of China		O-41, O-66	Yes	Yes
MAEKAWA	Masa-aki	Nagano Environmental Conservation Research Institute	Japan	P- 55		Yes	No
MALEQUE	Md. Abdul	Graduate School of Science and Technology, Kobe University	Japan	P- 18		Yes	No

MARUYAMA	Junkoh	Obihiro Univ. of Agric. and Veteri. Medicine	Japan		P- 7	Yes	Yes
MASUDA	Takuro	Faculty of Engineering, Kagawa University	Japan		O-36	Yes	Yes
MASUZAWA	Tadashi	Regional Environmental Planning Inc.	Japan	P- 3		Yes	Yes
MATSUMOTO	Hitoshi	The University of the Air	Japan	O-45		Yes	Yes
MATSUURA	Mitsuaki	western district park office bureau of construction Tokyo Metropolitan Government	Japan	P- 26		Yes	No
MINAGAWA	Tomoko	Aqua Restoration Research Center, Public Works Research Institute	Japan	P- 97	O-56, P-103	No	No
MIYAKE	Yo	Faculty of Engineering, Ehime University	Japan	P-108		No	Yes
MIYOSHI	Iwao	Kyoto Prefectural University	Japan	O-69		No	No
MORIMOTO	Junko	Hokkaido University	Japan	O-38		No	Yes
MORIMOTO	Yukihiko	Graduate School of Global Environmental Studies, Kyoto University	Japan	Open Symposium	O-33, O-54, O-61, P-4, P-24, P-70, P-71, P-74, P-75, P-78	Yes	Yes
MORIMURA	Atsuo	University of Human Environments	Japan	O-47		Yes	Yes
MOROI	Arimichi	Yokohama National University	Japan		P- 99	No	No
MOTOE	Michiko	Awaji Landscape Planning and Horticulture Academy	Japan	P- 36		Yes	Yes
MURAKAMI	Kentaro	Natural History Museum, Kishiwada City	Japan	P- 81		Yes	No
NA	Hyeyoung	Dept. of Public Administration, Inha University	Korea	P- 50	P- 49	No	No
NAGASAWA	Ryota	Tottori University	Japan	P- 12	O-35	No	Yes
NAGASHIMA	Keiko	Kyushu University, Graduate School of Bioresource and Bioenvironmental Science	Japan			No	No
NAKAGOSHI	Nobukazu	Graduate School for International Development and Cooperation, Hiroshima University	Japan	Open Symposium	O-5, P-59, P-73, P-100, P-101, P-102	Yes	Yes
NAKAMURA	Akihiro	Osaka Prefecture University	Japan	P- 34		Yes	Yes
NAKAMURA	Futoshi	Hokkaido University	Japan	O-55	O-19, O-38, O-57, P-5	Yes	Yes
NAKAMURA	Koji	Institute of Nature and Environmental Technology, Kanazawa University	Japan	O- 9	O-11, O-12, O-13, O-17, O-49	Yes	Yes
NAKANO	Daisuke	Department of Forest Sciences, Hokkaido University	Japan	O-19		No	Yes
NAKASHIMA	Atsushi	JSRT / Wakayama University	Japan	P- 29	P- 61	Yes	Yes
NAKATSUBO	Takayuki	Graduate School of Biosphere Science, Hiroshima University	Japan		P- 89, P- 90	No	No

NANDA	Aung	Engineering Ecology Lab., Dept. of Environmental Science & Human Eng., SAITAMA University	Japan	P-110	P-109	No	No
NATUHARA	Yoshiro	Osaka Prefecture University, Grad. School of Life & Environ. Sci	Japan	O-42	O-61	Yes	Yes
NEGISHI	Junjiro	Aqua Restoration Research Center, Public Works Research Institute	Japan			No	Yes
NEMOTO	Jun	Nationl Institute of Advanced Industrial Science and Technology	Japan	P- 61		Yes	Yes
NISHIHIRO	Jun	Department pf Ecosystem Studies, Graduate School of Agricultural and Life Sciences, The University of Tokyo	Japan	Plenary talk	O-24		
NISHIO	Norihiko	Faculty of Horticulture, Chiba University	Japan	P- 79	P-77	No	No
NISHIO	Tatsuji	National and Regional Planning Bureau,Ministry of Land,Infrastructure and Transport	Japan	P- 84		No	No
NISHIWAKI	Aya	Director of University Farm, Fiel Science Center, Faculty of Agriculture, University of Miyazaki	Japan	P- 33	O-31	No	Yes
NIWA	Hideyuki	Graduate School of Global Environmental Studies, Kyoto University	Japan			Yes	Yes
NONOMURA	Atsuko	Kagawa University	Japan	O-36		No	No
OBASE	Keisuke	Laboratory of Forest Resource Biology, Division of Environmental Resources,Graduate school of Agriculture, Hokkaido University	Japan	P- 22		No	Yes
OGAWA	Hitoshi	College of Agriculture, Univ. Tamagawa	Japan	P- 64	P-63, P-65	Yes	Yes
OGURA	Asami	Graduate School of Biosphere Science, Hiroshima University	Japan	P- 89		Yes	Yes
OHNO	Keiichi	Faculty of Environment & Information Sciences, Yokohama National Univ.	Japan	O-43	P-99	No	Yes
OHTAGAKI	Ryou	Tottori University	Japan	P- 76			Yes
OKU	Hirokazu	Forestry and Forest Products Research Institute, Kansai Research Center	Japan	P- 45	O-70	Yes	No
OOISHI	Yoshitaka	Lab. of Landscape Architecture, Graduate School of Agriculture Kyoto University	Japan	P- 70		No	Yes
OSAWA	Satoshi	Faculty of Policy Management, Keio University	Japan	P- 86	P-94	Yes	No
OTSUKA	Moriyasu	HEADS CO., LTD.	Japan	P- 83		No	Yes
OYABU	Takashi	Institute of Natural and Environmental Sciences, Univ. of Hyogo, Dept. of Landscaping Plants / Awaji Landscape Planning and Horticulture Academy	Japan		O-16, P-36, P-54	No	

PAGDEE	Adcharaporn	Department of Environment Science, Faculty of Science, Khon Kaen University	Thailand	O-67		Yes	No
PARK	Chong-Hwa	Seoul National University	Korea		P-67, P-68	Yes	Yes
PENG	Shaolin	Ecology and Evolution Institute Sun Yat-sen University//State Key Laboratory of Biocontrol, School of Life Sciences, Sun Yat-Sen University	P. R. of China	O-40, P-11		Yes	Yes
PUTRA	Ramadhani Eka	Institute of Nature and Environmental Technology, Kanazawa University	Japan	O-49		Yes	No
REN	Hai	South China Botanical Garden, the Chinese Academy of Sciences	P. R. of China	O-65		Yes	Yes
SAEKI	Ikuyo	Laboratory of Landscape Ecology, Faculty of Agriculture, Tokyo University of Agriculture and Technology	Japan	O-15		No	Yes
SAITOU	Daisuke	Graduate School for International Development and Cooperation (IDEC), Hiroshima University	Japan	P-102	P-100	No	Yes
SAKAMOTO	Keiji	Graduate School of Environmental Science, Okayama University	Japan	O-53		Yes	Yes
SAKANAKA	Keita	Faculty of systems engineering Wakayama university	Japan			Yes	No
SAKIO	Hitoshi	Forest Laboratory, Saitama Prefectural Agriculture & Forestry Research Center	Japan	O-29		Yes	Yes
SANESI	Giovanni	greenLab-Dept. of Plant Production Science, University of Bari	Italy	Open Symposium			
SANTIAGO-FANDINO	Vicente	Chief of Freshwater Management Unit, UNEP-IETC	Japan	O-62		No	No
SASAKI	Takeshi	Graduate School of Agriculture, Kyoto University	Japan	P-74	P-75	Yes	No
SASAKI	Yasushi	Department of Civil and Environmental Engineering, Saitama University	Japan		O-7, O-46, O-67	Yes	No
SASAKI	Yoshio	Kyoto University Graduate School of Global Environmental Studies	Japan	P-24		Yes	Yes
SATO	Rui	Department of Ecosystem Engineering, Graduate School of Engineering, The University of Tokushima	Japan	O-20		Yes	No
SEINO	Satoquo	Graduate School of Arts and Sciences, The University of Tokyo	Japan	P-105			
SHARP	Alice	Environmental Technology Program Coordinator, Sirindhorn International Institute of Technology, Thammasat University	Thailand	Open Symposium			
SHIBATA	Shozo	Graduate School of Global Environmental Studies, Kyoto University	Japan	O-44	P-36	Yes	Yes

SHIMA	Kazuto	Graduate School of Environmental Science, Okayama University	Japan	P- 96		Yes	Yes
SHIMATANI	Yukihiko	Kyushu University	Japan	O-24	O-25	Yes	Yes
SHIMODA	Michiko	College of Environment & Disaster Research, Fuji Tokoha University	Japan	P- 98		Yes	Yes
SHOJI	Atsushi	Lab. Grassland Management, National Agricultural Research Center for Kyushu Okinawa Region	Japan	O-52		Yes	
SINGH	Anand Narain	Department of Botany, Panjab University, Chandigarh	India	P- 10		Yes	Yes
SIONG	Kian	Applied Ecological Laboratory, Dept. of Environmental Science & Human Engineering, Saitama University	Japan	P-111		No	No
STOROZHENKO	Sergey Yurievich	Senior Scientist, Institute of Biology and Soil Science, Far Est Branch of Russian Academy of Sciences	Russia	O-10		Yes	Yes
SUGIURA	Toshihiro	Japanese Society of Revegetation Technology	Japan	P- 17	P- 40	No	Yes
SUGIYAMA	Keiichi	FUJI TOKOHA University	Japan	P- 53		No	Yes
SUZUKI	Chiaki	Chiba University Graduate School of Science and Technology	Japan	P- 31		No	No
SUZUKI	Shigeo	Hiroshima University, Graduate School for International Development and Cooperation	Japan	P- 59	P-101	Yes	Yes
SUZUKI	Toru	EnVision Conservation Office	Japan	P- 30	P- 8, P-32, P-85	No	No
SUZUKI	Wataru	Biodiversity Policy Division, Ministry of the Environment of Japan	Japan	O-63		Yes	No
SUZUKI	Yumiko	Kitasato University	Japan			No	No
TABATA	Keizo	Graduate school of life and environmental sciences, Osaka prefecture university	Japan	P- 78	P-70, P-71	No	Yes
TACHIBANA	Ryuichi	INOUE MASASHOUTEN CO LTD.	Japan	P- 20		No	No
TAGAMI	Masaaki	Commemorative Organization for the Japan World Exposition '70	Japan			No	No
TAKADA	Masayuki	Hokkaido Institute of Environmental Sciences	Japan	P- 85	P- 95	No	No
TAKAHASHI	Mayumi	Department of Forest Science, Graduate School of Agriculture, Hokkaido University	Japan	O-57		Yes	No
TAKAHASHI	Terumasa	Faculty of Horticulture, Chiba University	Japan	P- 77	P-56, P-79	No	No
TAKASUKA	Toshiyuki	Biodiversity Policy Division, Ministry of the Environment of Japan	Japan	P- 47		Yes	No
TAKAZAKI	Hirotohi	College of Agriculture, Univ. Tamagawa	Japan	P- 65	P-63, P-64		
TAKEMON	Yasuhiro	Water Resources Research Center, DPRI, Kyoto University	Japan		O-57		
TANAKA	Katsuyuki	Kitasato University	Japan	P- 40		No	No

TANAKA	Norio	Department of Civil and Environmental Engineering, Saitama University	Japan	O- 7	O-23, O-60	Yes	No
TANIMOTO	Shigeru	Japan Association for Landscape Ecology	Japan			Yes	No
TASHIRO	Takashi	Aqua Restoration Research Center	Japan	P-103	O-56, P-97	No	Yes
TAZAKI	Fuyuki	Hokkaisuiko Consultant Co., Ltd.	Japan	P- 7	P-16	Yes	Yes
TSAI	Hou-Nan	Landscape Architecture Program, Graduate Institute of Horticulture, School of Bio-Resource and Agriculture, National Taiwan University	Taiwan	Open Symposium			
TSUZUKI	Takayoshi	Research Division 1, Foundation for Riverfront Improvement and Restoration	Japan	P-112		No	No
UCHIDA	Taizo	Graduate School of Agriculture, Hokkaido University	Japan	P- 16	P-7	Yes	Yes
UEMURA	Kunio	Kinki Chugoku Regional Forest Office	Japan	P- 9		Yes	No
UNEMOTO	Masashi	Commemorative Organization for the Japan World Exposition '70	Japan			No	No
URATO	Hideyuki	Regional Environmental Planning Inc.	Japan			Yes	No
UTSUGI	Etsuko	Ryokusei Research Institute, Inc	Japan		P-25	Yes	Yes
UTSUNOMIYA	Daisuke	Kanazawa University Graduate school of Natural Science and Technology	Japan	O-17		No	No
UY	Pham Duc	Graduate school of international development and cooperation (IDEC)	Japan	P- 73		Yes	Yes
WATANABE	Sonoko	Graduate School for International Development and Cooperation, Hiroshima University	Japan		Open Symposium, P-52	Yes	Yes
WEI	Wei	Research Center for Eco-Environmental Sciences, Chinese Academy of Sciences	P. R. of China	P-66			
WHANG	Bo-Chul	Chonbuk National University	Korea	Open Symposium			
WU	Yaqiong	State Key Laboratory of Systems Ecology, Research Center for Eco-Environmental Sciences, Chinese Academy of Sciences	P. R. of China	P- 41	P-6	Yes	Yes
YAMABA	Atsushi	Hiroshima Prefectural Forestry Research Center	Japan	P- 52		Yes	No
YAMADA	Hiroyuki	Research Group of Regional Environment, Graduate School of Agriculture, Hokkaido University	Japan	O-58	O-59	Yes	Yes
YAMADA	Mamoru	HIROSHIMA UNIVERSITY	Japan			Yes	Yes
YAMADA	Ren	RONTAI Co.,LTD.	Japan			Yes	Yes
YAMAGAWA	Hiromi	Faculty of Agriculture, University of Miyazaki	Japan	P- 1		Yes	No
YAMAGUCHI	Takashi	Director of HEADS CO., LTD.	Japan			No	No
YAMAMOTO	Masanori	Graduate School of Systems Engineering Wakayama University	Japan		P-29	Yes	Yes

YAMAMOTO	Satoshi	University of Hyogo / ALPHA	Japan	P- 51	P- 36, P-54	Yes	Yes
YAMANE	Masanobu	Kanagawa Prefectural Natural Environment Conservation Center	Japan	P- 8	P-30, P-32	Yes	Yes
YAMASHITA	Keigo	Tokushima University	Japan	P- 35		Yes	Yes
YAMASHITA	Sampei	Department of Civil and Urban Design Engineering, Kyushu Sangyo University	Japan	O- 3		Yes	Yes
YANAI	Seiji	Hokkaido Institute of Technology	Japan	P- 95	P-87	Yes	Yes
YANG	Jeon young	Chung-Ang University	Korea		O-22	Yes	Yes
YANG	Liu	Key Lab. of Systems Ecology, Research Center for Eco-Environmental Sciences, Chinese Academy of Sciences	P. R. of China	O-39		Yes	No
YOKOTA	Junichiro	Tottori University	Japan	P- 28			Yes
YOKOYAMA	Hideji	Kyushu Sangyou University	Japan			No	Yes
YOSHIDA	Hiroshi	Toko Corporation	Japan			Yes	Yes
YOSHIDA	Tsuyoshi	Research Scientist, Japan Wildlife Research Center	Japan	P- 32	P- 8, P-30	No	No
YOSHIKAWA	Ken	Okayama University, Graduate School of Environmental Science	Japan	P- 19	O-53	No	Yes
YOSHIMURA	Chihiro	Interdisciplinary Graduate School of Medical and Engineering, University of Yamanashi	Japan	P- 88		No	No
YOSHITOMI	Tomoyasu	Tokyo Gakugei University	Japan	P- 48		Yes	
YOSHIZAKI	Shinji	Musashi Institute of Technology	Japan			No	No
YUTANI	Kentaro	Saitama University	Japan	O-60		No	No
ZHU	Wei-Hong	Geography Department of Yanbian University, China; Graduate School of Global Environmental Studies, Kyoto University	Japan	O-54		Yes	Yes